

COMMUNITY NOTICE

Bineshii Business Park Expansion

Unauthorized Access to Construction Site

September 29, 2023 – The project team for the Bineshii Business Park Expansion Project near Yellek wishes to remind community members and the public that unauthorized access to the construction site is not permitted for safety reasons. This includes pedestrians and all motor vehicles travelling from any direction.

With hunting season upon us and more members using their ATVs to get out on the land, we want to ensure that everyone is safe while they are out enjoying their leisure activities. Please respect all posted signage and areas that are coned off on the work site (see map on page 2).

As an active construction site, the Bineshii Business Park Expansion area poses many hazards, especially to the public who don't know the risks as well as the site crew do.

These **safety risks** include, but are not limited to:

- blasting activities
- heavy equipment operations
- uneven ground and stockpile areas
- unfinished work areas (i.e. a road that abruptly ends)
- deep ditches and stormwater management ponds

Miigwech for your cooperation in avoiding the work site until construction is completed later this year.

If you have any questions or concerns, please contact:

Bruce McLeod, Project Manager
Nipissing First Nation
705-498-2520
brucem@nfn.ca

Gen Couchie, Business Operations Manager
Nipissing First Nation
705-471-1545
genc@nfn.ca

Background

The Bineshii Business Park is currently home to 10 NFN businesses and the Kinoomaadziwin Education Body's head office. The expansion project will create road access and utility services for 23 new commercial and light industrial lots, which will generate revenue for Nipissing First Nation along with business and employment opportunities for members in various sectors.

Community Notice – September 29, 2023

Bineshii Business Park Expansion: Unauthorized Access to Construction Site

The Bineshii Business Park is 76 acres in size, with average lot sizes being 2-acres. The Park is located on Highway 17 across from Yellek, just minutes west of North Bay.



NIPISSING FIRST NATION BINESHII BUSINESS PARK

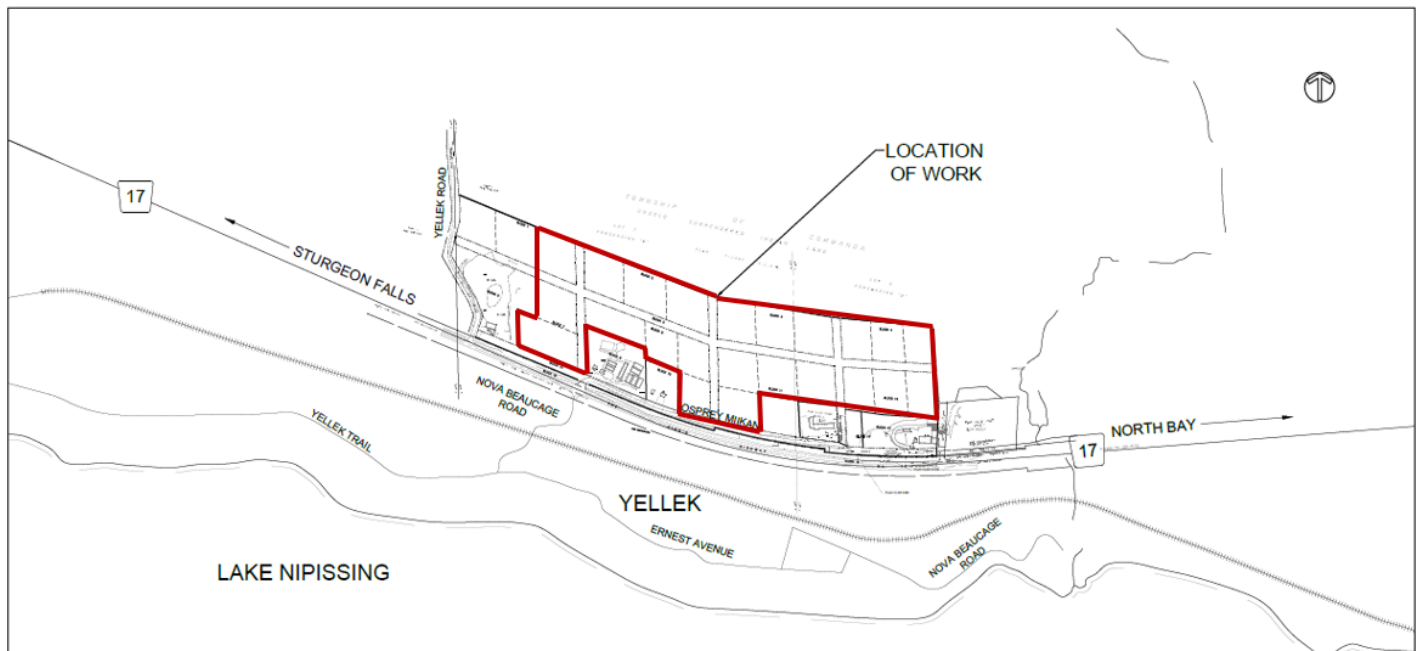

KEY PLAN